



ASPEN MEADOWS

SALAMANDER COLLECTION

WALKING TIME: 8 minutes

- 1 Walter Isaacson Center to
- 10 Walter Paepcke Memorial Building

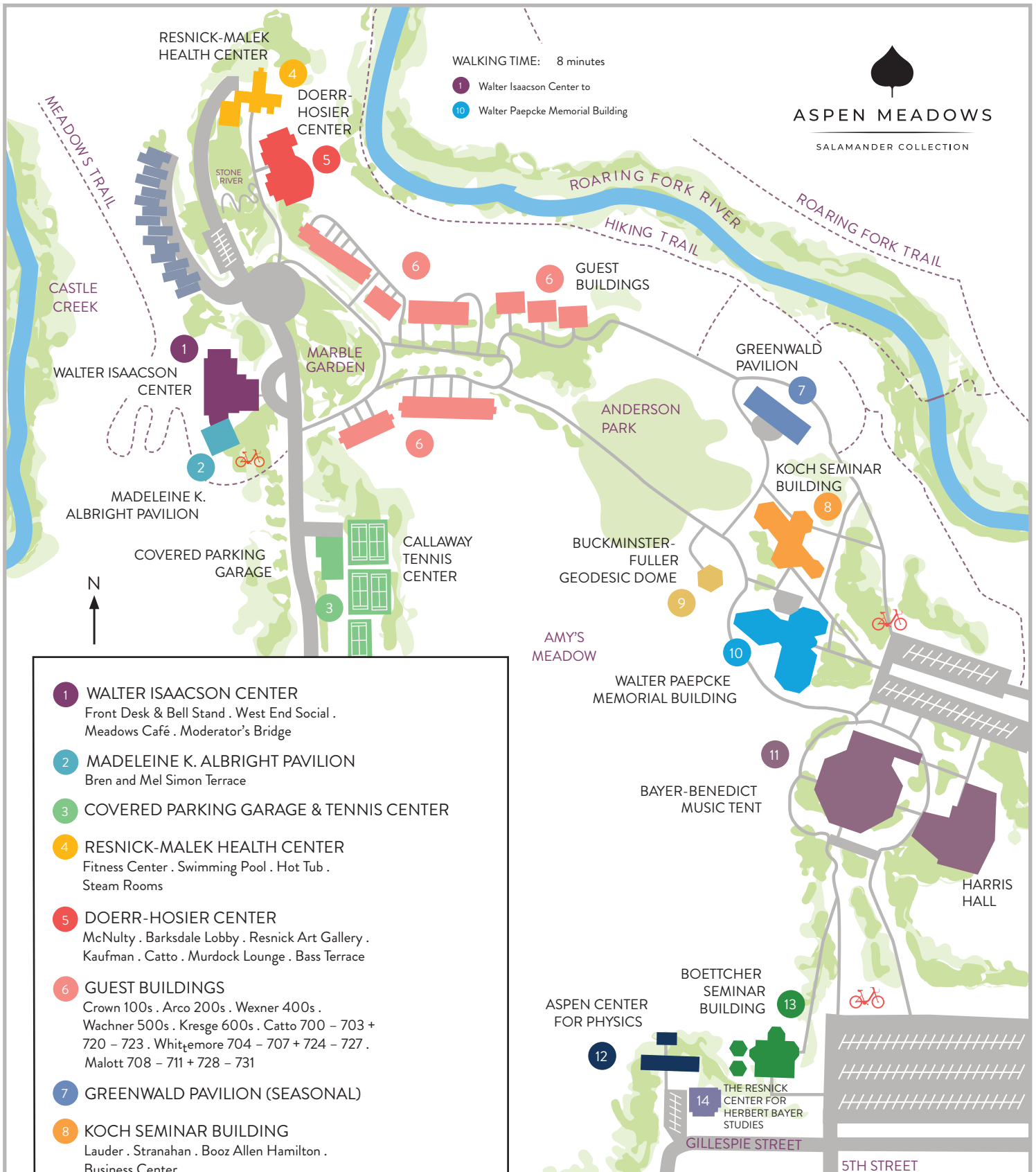

- 1 WALTER ISAACSON CENTER
Front Desk & Bell Stand . West End Social . Meadows Café . Moderator's Bridge
- 2 MADELEINE K. ALBRIGHT PAVILION
Bren and Mel Simon Terrace
- 3 COVERED PARKING GARAGE & TENNIS CENTER
- 4 RESNICK-MALEK HEALTH CENTER
Fitness Center . Swimming Pool . Hot Tub . Steam Rooms
- 5 DOERR-HOSIER CENTER
McNulty . Barksdale Lobby . Resnick Art Gallery . Kaufman . Catto . Murdock Lounge . Bass Terrace
- 6 GUEST BUILDINGS
Crown 100s . Arco 200s . Wexner 400s . Wachner 500s . Kresge 600s . Catto 700 - 703 + 720 - 723 . Whittemore 704 - 707 + 724 - 727 . Malott 708 - 711 + 728 - 731
- 7 GREENWALD PAVILION (SEASONAL)
- 8 KOCH SEMINAR BUILDING
Lauder . Stranahan . Booz Allen Hamilton . Business Center
- 9 BUCKMINSTER-FULLER GEODESIC DOME
- 10 WALTER PAEPCKE MEMORIAL BUILDING
Auditorium . Gallery . Library
- 11 MICHAEL KLEIN MUSIC TENT & HARRIS HALL

- 12 ASPEN CENTER FOR PHYSICS
- 13 BOETTCHER SEMINAR BUILDING
Dingman . Harris . Hudson Commons
- 14 THE RESNICK CENTER FOR HERBERT BAYER STUDIES

WE-CYCLE STATION



ASPEN MEADOWS

SALAMANDER COLLECTION

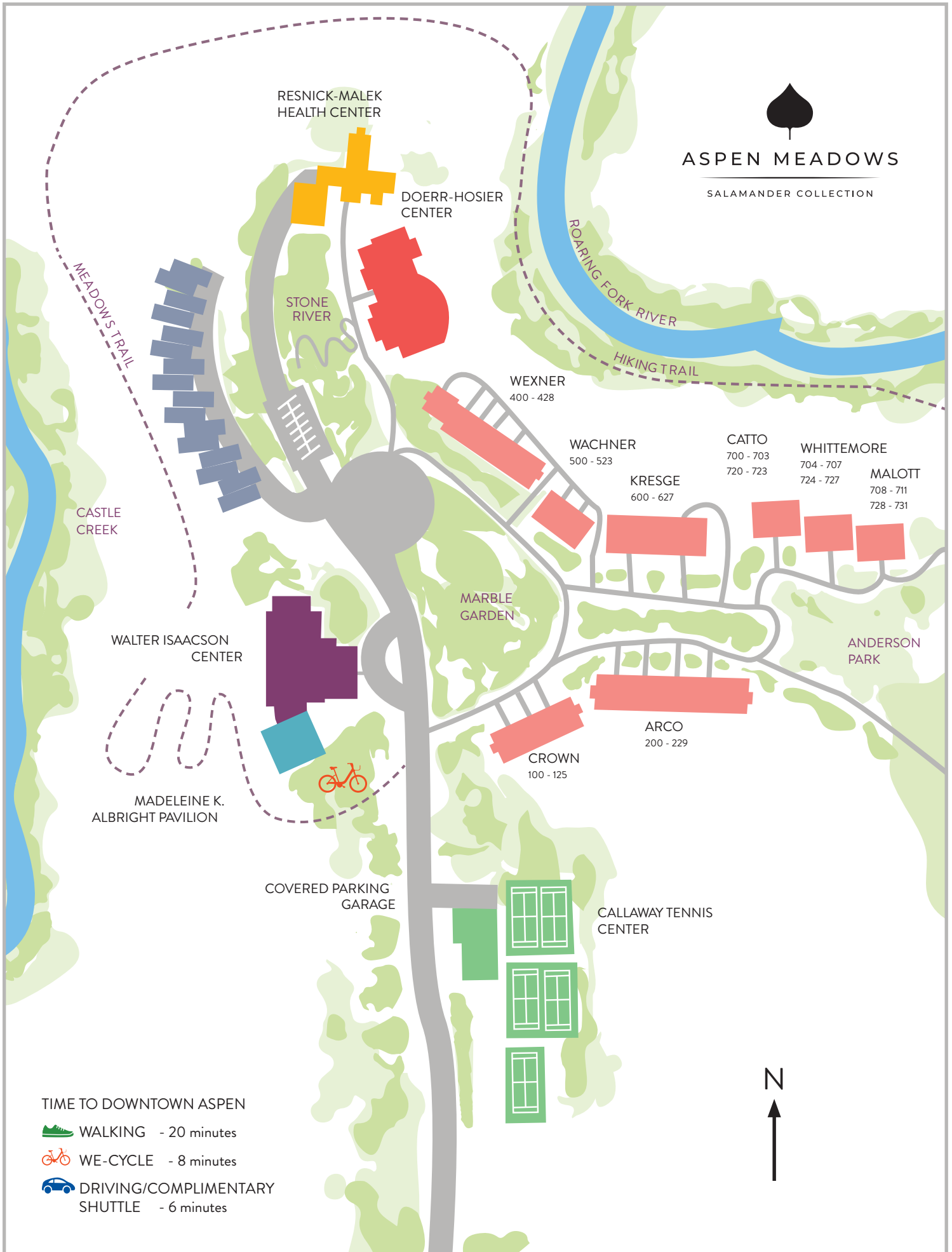

RESNICK-MALEK
HEALTH CENTER

DOERR-HOSIER
CENTER

STONE RIVER

WEXNER
400 - 428

WACHNER
500 - 523

CATTO
700 - 703
720 - 723

WHITTEMORE
704 - 707
724 - 727

MALOTT
708 - 711
728 - 731

KRESGE
600 - 627

MEADOWS TRAIL

ROARING FORK RIVER

HIKING TRAIL

CASTLE CREEK

MARBLE GARDEN

WALTER ISAACSON
CENTER

ANDERSON
PARK

MADELEINE K.
ALBRIGHT PAVILION



COVERED PARKING
GARAGE

ARCO
200 - 229

CROWN
100 - 125

CALLAWAY TENNIS
CENTER

TIME TO DOWNTOWN ASPEN

WALKING - 20 minutes

WE-CYCLE - 8 minutes

DRIVING/COMPLIMENTARY
SHUTTLE - 6 minutes

